

# IntraPac Bottle Caps

Select from these various sizes and types of caps for any of the IntraPac oval or round roll-on bottles, HDPE or PET bottles.

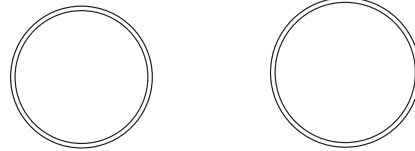
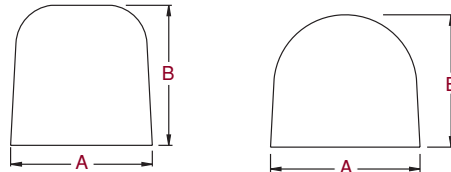

187B

187C

## CAP FOR 1.4" ROLL-ON BALL

STYLE	A mm/inches	B mm/inches
187B	48.2 / 1.897	47.6 / 1.874
187C	48.0 / 1.889	42.5 / 1.673

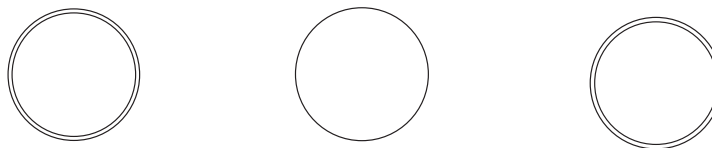
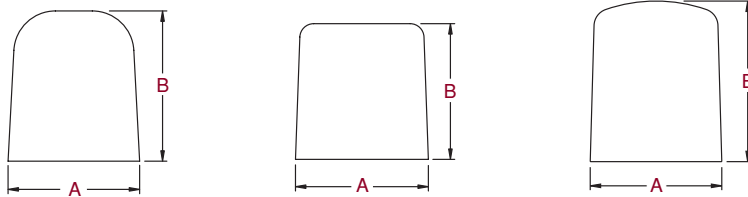

187A

187D

192E

## CAP FOR 1" ROLL-ON BALL

STYLE	A mm/inches	B mm/inches
187A	38.0 / 1.496	43.3 / 1.704
187D	38.4 / 1.511	39.2 / 1.543
192E	38.0 / 1.496	46.4 / 1.826

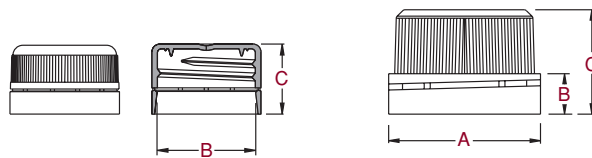

153 and 188

191

## TAMPER EVIDENT CAP

STYLE	A mm/inches	B mm/inches	C mm/inches
153	27.3 / 1.074	24.8 / 0.976	17.6 / 0.692
188	30.6 / 1.205	27.2 / 1.071	19.2 / 0.756
191	25.2 / 0.992	6.7 / 0.263	17.3 / 0.681

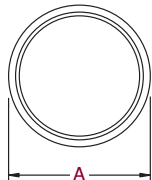
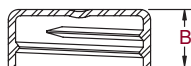

153B

## REGULAR CAP

STYLE	A mm/inches	B mm/inches
153B	27.3 / 1.074	11 / 0.433

*IntraPac reserves the right to change or modify the design of its products without any obligation to provide notification of change or intent to change.*

